

THE TOWN HOME

1,771 SQ FT · 3 BED · 3 BATH



Edgewater Hill



Introducing the Pinepointe Townhomes. This beautifully crafted townhome has stunning curb appeal. The unique design of this home is found in its charming details such as decorative braces and columns, distinctive shutters, and 2 car garage. Beyond the two-story entry the island kitchen opens up to the living and dining room which each have 12-foot-high ceilings. The main-level master suite ceiling is also 12 feet high. The dining room and living rooms are lined with windows allowing plenty of sunlight to bathe the rooms. A generous allowance for cabinetry, lighting, and appliances will allow you to turn this kitchen and island into a dream oasis-customized to suit your style. Desirable features are found on the upper-level too, where both bedrooms have direct access to the bath and the staircase landing can be customized with additional built-ins. If you have been searching for Old World charm and character-your search is over.



**BERKSHIRE
HATHAWAY** | New England
HomeServices Properties

JOYCE COVONE

MOBILE: 860-608-1708

EMAIL: joycecovone@bhhsne.com

THE TOWNHOME FLOOR PLANS

- Total Sq. Ft. 1,771
- 3 Bedrooms
- 2 Full Bathrooms
- 1 Half Bathroom
- 2 Car Garage

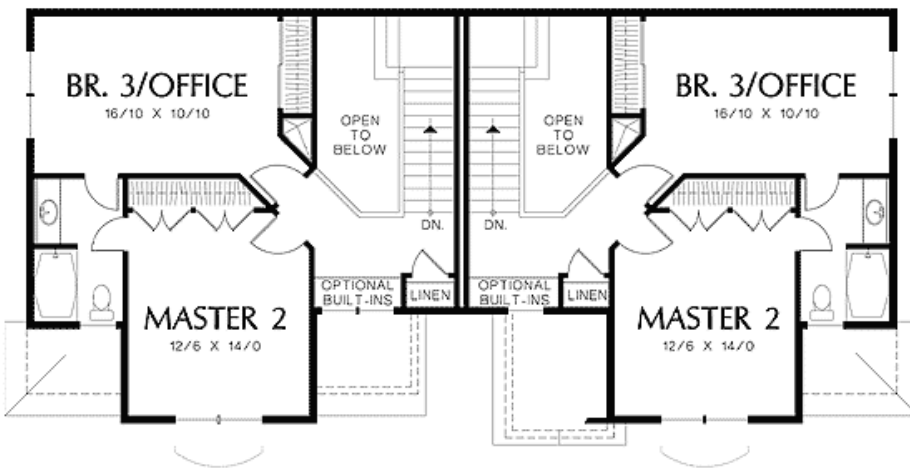
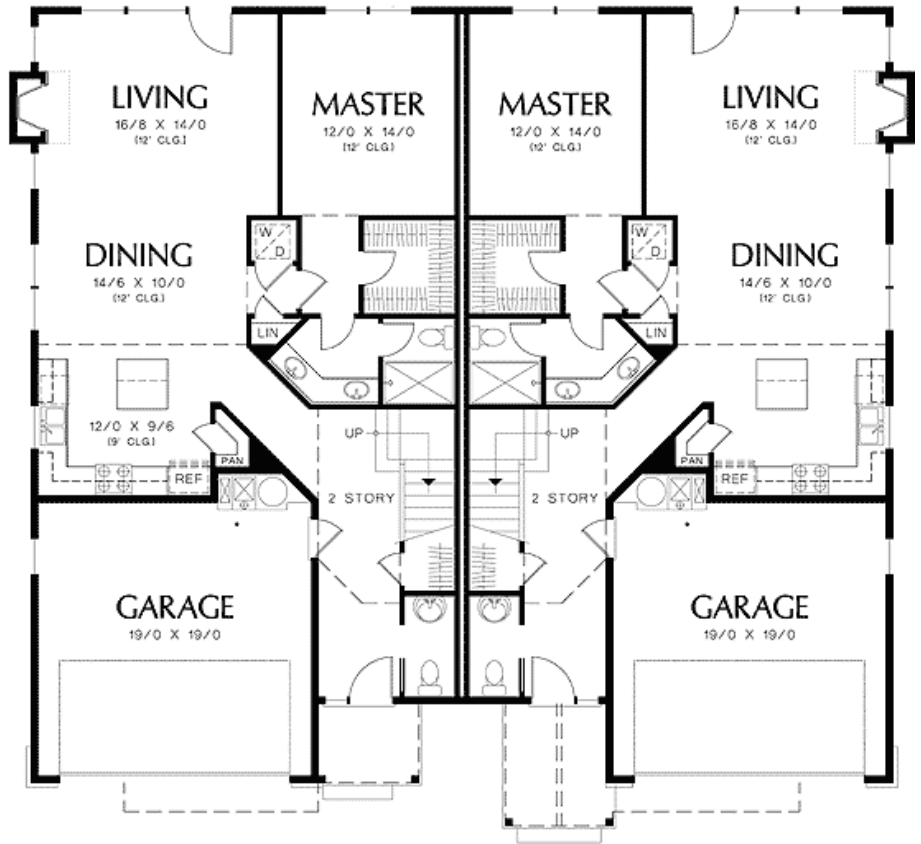

Edgewater Hill

VISIT US AT

EDGEWATERHILL.COM

This artistic rendering and floor plans represent the model depicted. Room dimensions are approximate and vary according to the field conditions. Builder reserves the right to alter dimensions and may substitute any item specified with a brand equivalent quality, provided the financial and structural integrity of the building is not compromised. The specification sheet supersedes all artistic renderings or plan. All specifications are subject to change, and the Builder reserves the right to make modifications or changes without notice or obligation. All building plans may be reversed (mirror image) from what is depicted on the artistic rendering elevations or the site plan map.